

GCS186

IMPORTANT: Measure project dimensions starting from the glass edge.

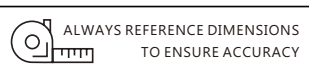

*Not shown to scale.

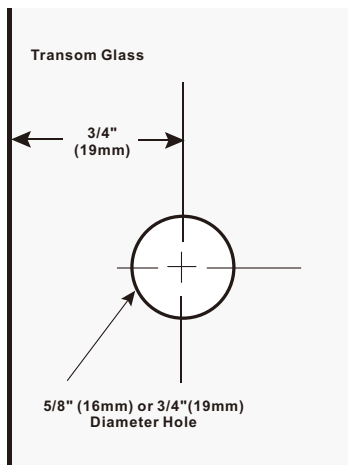
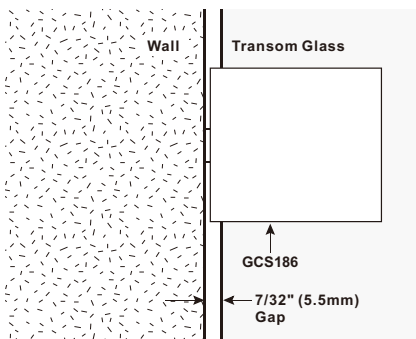
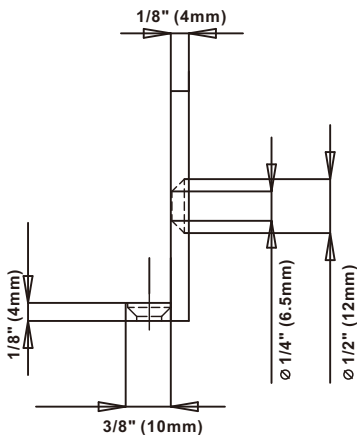
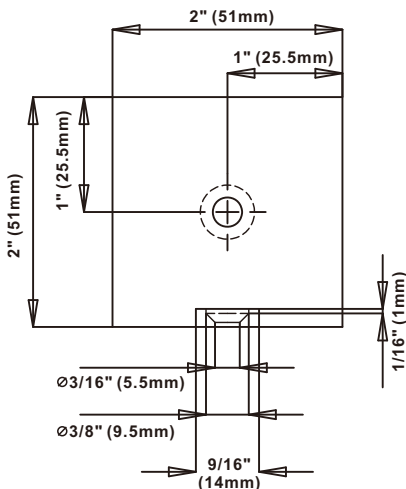

| Item Number | Glass size |
|-------------|---------------------------|
| GCS186 | 5/16" (8mm) - 1/2" (12mm) |

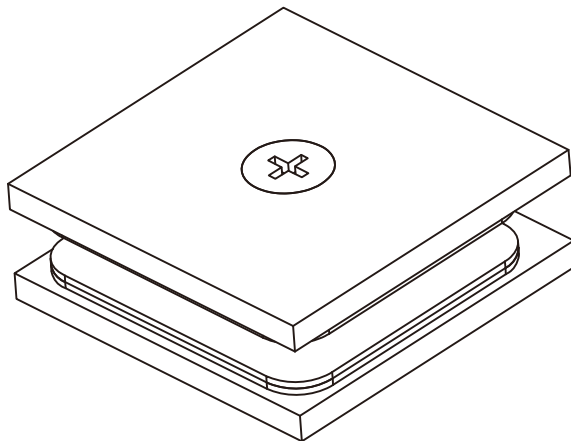
**Specifications:**

Glass Sizes: 5/16" (8mm) to 1/2" (12mm) thick tempered safety glass

Includes: Gaskets and template

Construction: Solid brass

Description:

GCS186- Square Wall Mount Movable Transom Clamp. Designed to rotate a movable transom off a wall.

Maximum transom size: 16" (406mm) x 30" (406mm)

Recommendations:

To ensure public safety, we strongly advise using only tempered safety glass.

Maintenance:

• Avoid the use of abrasive cleaners on the hardware. Some components feature a delicate clear lacquer coating that could suffer irreparable harm from harsh chemicals. It's recommended to inform your customers that daily maintenance involving drying the hardware with a clean, soft towel. In cases where mineral deposits accumulate, create a solution by adding a few drops of mild liquid soap (such as Ivory or a comparable product) to a cup of warm water. Employ a soft, non-abrasive cloth to clean the hardware, then ensure a thorough rinse with clean, warm water, followed by proper drying.

UNIKOO LIMITED WARRANTY:

- UNIKOO warrants it's Shower Door Hardware for a period of 3 years from the date of purchase. UNIKOO Shower Door Hardware is warranted against material and workmanship defects.
- All warranty claims are subject to inspection by UNIKOO before providing a resolution against the warranty claim.
- This warranty is void if it is determined after UNIKOO inspection that the Hardware has been improperly installed and/or maintained in a manner not conforming to UNIKOO guidelines and instructions provided at time of purchase.
- UNIKOO's responsibility to provide a resolution under said warranty will be limited to a refund of purchased price or provide a replacement for the hardware.
- The refund or replacement will constitute UNIKOO's limited liability and obligation for any and all defective material/workmanship for said warranty claim.
- THIS WARRANTY IS EXCLUSIVE AND UNIKOO MAKES NO OTHER WARRANTY, EXPRESSED OR IMPLIED.