

# UKH10-LH90IN/UKH10-LH180

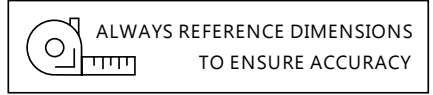

\*Not shown to scale.

## Installation instructions

Lever Hinge Wall Mount 90 Degrees  
/Lever Hinge Glass To Glass 180 Degree

- 1** Place a glass panel with ready-made glass notches on a flat surface, clean the area where the hinges will be installed with cleaning naphtha or alcohol to make sure there is no oil or dirt on the surface and fix the lever hinges to the glass panel.

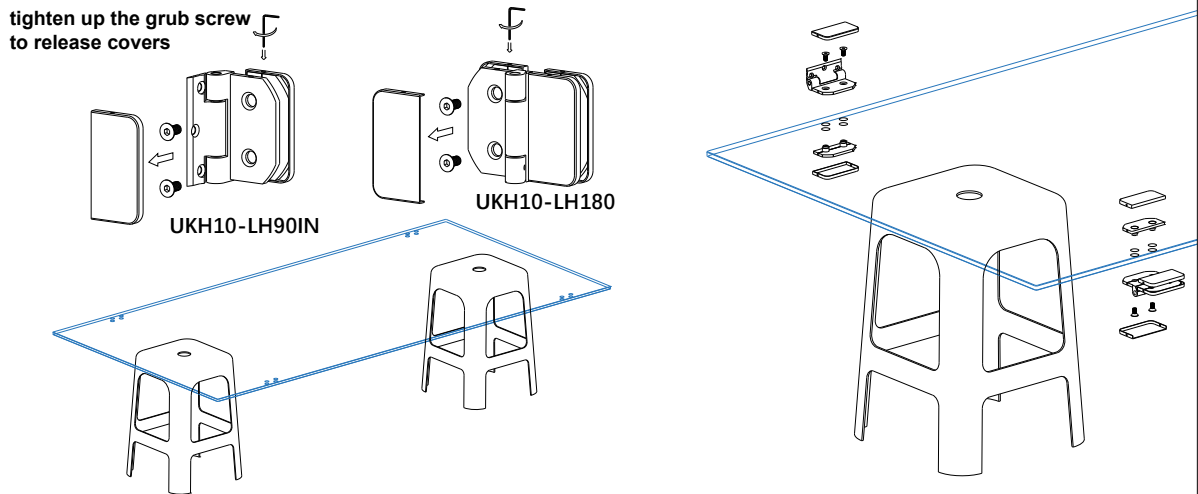

- 2** Place spacers below the glass panel as support, follow below steps to drill holes on the wall. Fix the panel with the hinges to the wall and check door opening/closing function are correct. Make sure to mount one panel to the wall prior to mounting the second panel onto the glass.

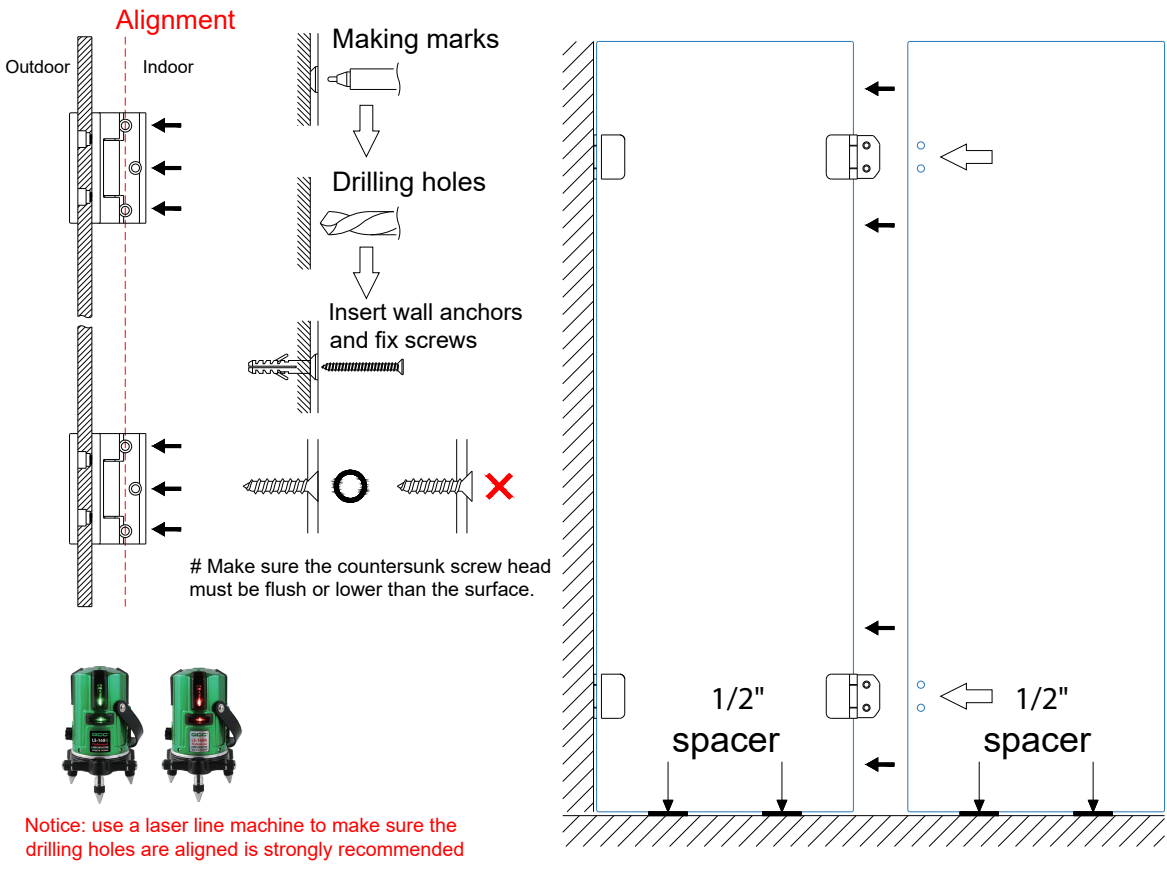

# UKH10-LH90IN/UKH10-LH180

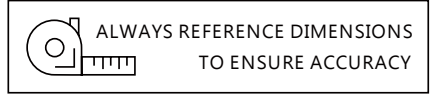

\*Not shown to scale.

## Installation instructions

Lever Hinge Wall Mount 90 Degrees  
/Lever Hinge Glass To Glass 180 Degree

1

Max. weight: 132lbs(60kg)/2 panels

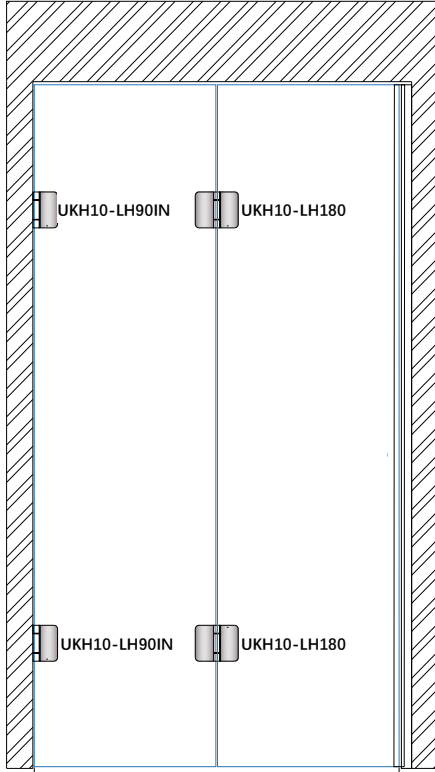

Max. width of 35-7/16"(900mm)

Condition: require UKH10-LH90IN hinge x 2pcs

Max. weight: 187lbs(85kg)/2 panels

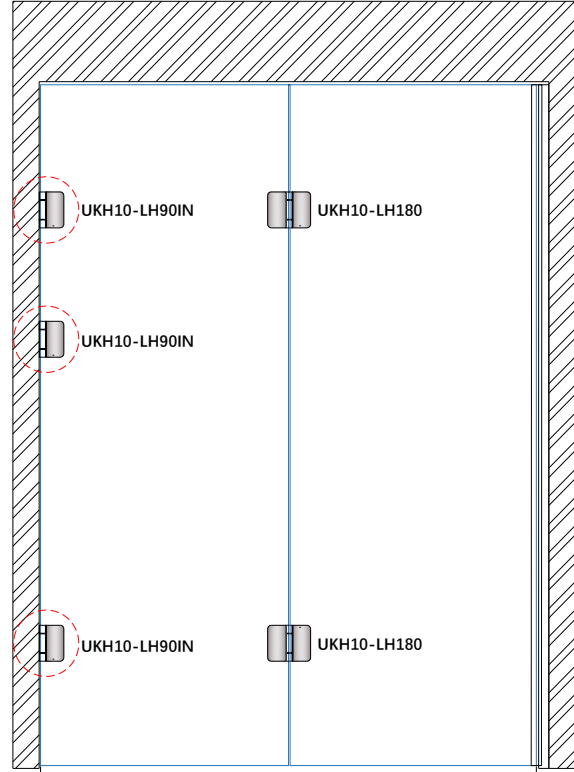

Max. width of 47-1/4"(1200mm)

Condition: require UKH10-LH90IN hinge x 3pcs

2 Magnetic PVC seal PDJ-90/180-MG-3/8-80

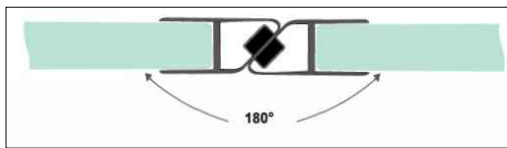

PDJ-90/180-MG-3/8-80

#For glass thickness : 3/8"(10mm)

#length in 80"(2032mm) /pc.

#purpose: seal the water and hold the panel



3 Scene A - with a fixed glass panel

options:   
1. stainless steel U channel  
2. glass fitting/clamp

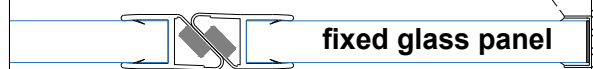

4 Scene B - without a fixed panel

Use a 3/8"x 3/8" (10x10mm) aluminum rod fix to the wall, and install the PDJ-90/180-MG-3/8-80

